



# INFORMATION BULLETIN

## No.008

**TO** : All CCS Lightning Dealers

**DATE** : October 1, 2007

**SUBJECT** : **NEW APU SERVICE SWITCH AVAILABLE**

The **APU service switch** P/N 1071205 allows the user to disable automatic starts (low battery, low temperature, timed starts etc) or to start and stop APU without entering the truck.

It is to be mounted in a location that allows access to the switch without entering the truck, in most cases it is installed in proximity of the cargo door. It uses the remote start connector on the power distribution box and can not be used in conjunction with keyless remote starter.

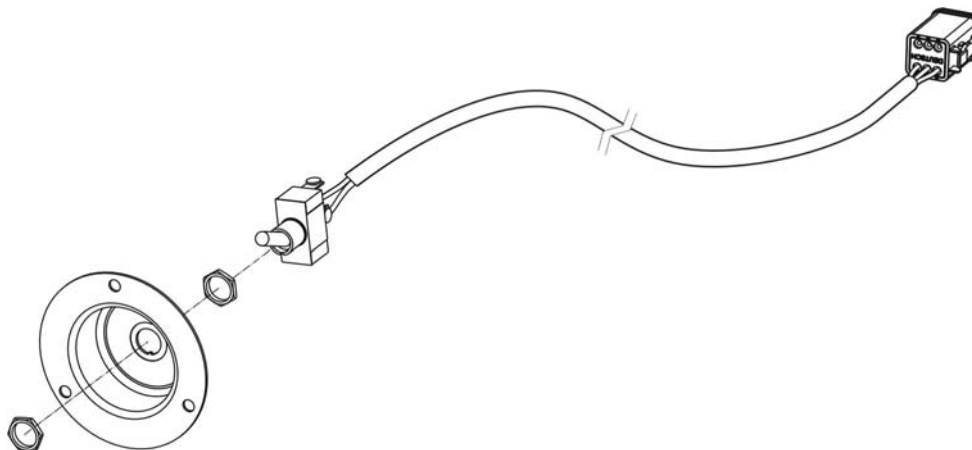

CCS\_IM\_106